



Opticlux - Ceiling LED magnifier

The award winning Opticlux is designed with everything a modern magnifier luminaire is meant to have: a robust 1.9x magnifier, the latest, maintenance free LED modules, an extensive 1200mm reach with ergonomically-tested arm joints and a highly intuitive operation.

- Bright, Homogenous light field of 6000 Lux @ 0.15m
- Large viewing field of Ø153mm
- Colour temperature daylight white 6500 K
- Continuously dimmable
- Colour rendering properties
- Acrylic lens with 35 dioptres provides 1.9x magnification
- Arm length 1100mm

Ceiling Model

(with 115cm pole - can be cut to length)

RBKML164

\$2695



Also available - Opticlux with woods light

RBKML166

\$2995

The special model variant for dermatologists, veterinarians and forensic medicine combines two lighting modes in one device: daylight white illumination and Woods light. This means that different examinations can be performed with just one light. Other Woods lamps require the room to be completely darkened to use, thanks to the powerful Ultraviolet BLB LED's the Opticlux doesn't need this.



For more information download the product brochure from our website

MLD Magnifier Luminaire

A perfect combination of optimum near vision and high light quality.
The light can be used wherever the human eye comes up against its limits.

- LED technology
- Colour temperature neutral white 5000 K
- Colour rendering Ra > 80
- Glare-free thanks to satinised screen
- Hard-coated plastic lens Ø 160 mm with 3.5 dioptres
- Housing made of colourless anodised aluminium and grey plastic
- Polycarbonate plastic screen
- Ergonomic linkage technology with 2D head joint
- Membrane key integrated into the luminaire head for On/Off and dimming
- Includes table clamp (0 – 70 mm)
- 2-year warranty

RBKML152

\$539



For more information download the product brochure from our website

Tevisio - LED magnifier light

With the latest LED's, innovative arm technology and a visual field designed for optimum performance, the TEVISIO magnifier luminaire combines high efficiency with ergonomic design.

- Unique lower arm assembly allows head to swing below bench/shelf height
- 48 premium SMD LEDs
- Continuous dimming to 10%
- 2 x magnification
- 6,000 lux output using only 14 watts
- Visualiser function for 3D shadow effects
- Large arm radius with innovative flexible head joint
- Balanced arm, easily adjustable
- Maintenance-free design with LED life up to 50,000+ hours
- Wide-angle lens Ø 153mm for distortion-free vision
- 784mm reach
- 2-year warranty

RBML160

\$1095

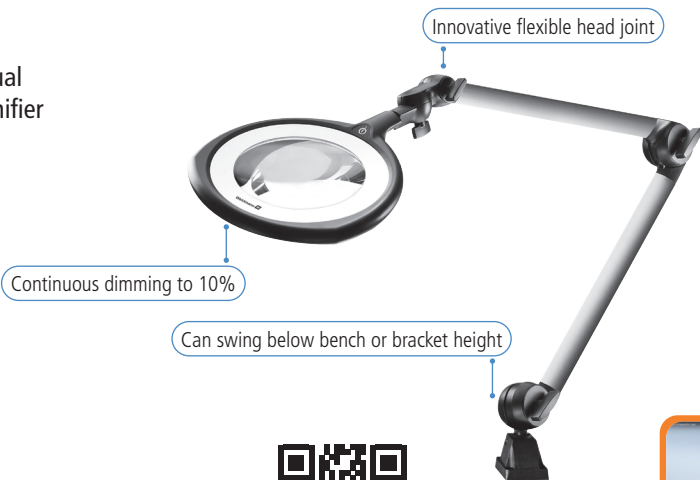

Visit our website to watch the product video



Maggylamp LED Examination light

The Maggylamp LED Examination Light with its flexible gooseneck arm and specifically selected colour corrected LED's offers flexibility, correct light output and colour required for surgery examinations.

- 40,000 Lux at 30cm
- 40,000 hour bulb life
- Cool white light, 5500°K colour
- Concise beam angle of 30°
- Operation switch on handle
- Low energy consumption, only 5 watt
- Low heat output
- Base and lamp head - Plastic housing
- Goose neck - Metal with silicone sleeving
- Wall or mobile mounted
- 2-year warranty

Wall Mount Model
Mobile Base Model

RBKML308LEDW
RBKML308LEDS

\$525



2YR
warranty



WE ARE A BUSINESS FOR GOOD

We may take it for granted, that the light turns on when we push the switch. This is not the case in many communities around the world. Every month, we at Team Medical help offset our carbon footprint as we donate **630 days of solar light each month** to families in tribal communities, rural mountain or forest areas. With a solar lamp, the families reduce the danger of fire and injury as well as improving the inside air quality. Adequate lighting goes a long way in supporting daily household tasks such as cooking and also allows children to study and complete their school work. Learn more about our giving impacts at www.teammed.com.au/teamgiving

B1G1 BUSINESS FOR GOOD



PML1 LED Examination Light

A great all-round diagnostic light

- 89,000 lux at 30cm
- Powerful long-life LED with up to 50,000 hours of operation
- Low energy consumption
- Comfortable guiding handle with integrated On/Off switch
- Mobile base and wall mount provided with every light
- Flexible goose neck allows multiple angle positioning
- Stepless dimmer control allows to set precise illumination

TMFPML1WH White
TMFPML1BL Black

\$395



PML2 LED Examination Light

6 powerful LED's offering powerful illumination

- 78,000 lux at 30cm
- Powerful long-life LED with up to 50,000 hours of operation
- Superb colour rendering
- Low energy consumption
- Mobile base and wall mount provided with every light
- Flexible goose neck allows multiple angle positioning
- Stepless dimmer control allows to set precise illumination

TMFPML2WH White
TMFPML2BL Black

\$525





PLANET MEDICAL

Seeing further ahead.
Lighting your way forward.

With the most trusted support and lighting design expertise in the industry, it's no wonder leading hospitals and practitioners choose Planet Lighting.

Upgrade today with our award winning Australian made medical lights featuring advanced LED technology, second-to-none durability, and effortless operation.



Planet Lighting founded in Melbourne by the Iggulden family who continue to run the company today

1911



PLANET
MEDICAL

Company begins manufacture and release of medical task lights

1960s



1960

Medical lighting division created



1980s

Release of the powerful and flexible UDP examination light which wins the prestigious Australian Design Award

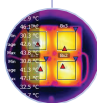

Planet Lighting commences research and development into high efficiency LED lighting

2002



Release of the Planet Lighting Phantom procedure light

2013



ULED X Examination light

Coming Soon

2010

Release of the Planet Lighting ULED LED examination light



2021

Sealed arm and antimicrobial coatings



Australian designed and
manufactured is just the beginning.

At the heart of Planet Medical is one of Australia's oldest and most iconic design and manufacturing success stories. Founded in 1911, Planet Lighting's journey to become one of Australia's most trusted providers of an extensive range of examination and surgical lights began over 60 years ago.

We continue to lead the way today.

We're the number one medical lighting supplier in Australian hospitals, meeting and exceeding some of the world's strictest quality requirements. But we don't stop there.



We design, manufacture and test in house so that our customers receive the benefit of our extensive medical lighting and lighting specialist expertise. And we back you with one of the best guarantees and support in the industry.

Planet Medical's early adoption and development of innovative technologies means our customers get the best of today's technology and tomorrow's. In fact, Planet Lighting is highly recognised as one of the world's premier industry solutions not only for medical lighting but also for integrated LED handrail and aquaculture lighting.

Contact us today to find out more.



PLANET
LIGHTING



FlexLED minor examination light

FlexLED is one of the most economical and flexible LED examination lights ever made in Australia. Perfect for general practices and workstations.

Over 20,000 lux at 1 metre and a 4000K colour temperature, unlimited range of movement with a hygienically sealed flexible arm and head. FlexLED allows the accurate positioning of the lamp head above any work surface.

- 60,000 lux at 30cm
- Colour temperature: 4,000K
- Colour rendering (Ra): 95
- Hygienically sealed arm and head
- IP65 On/Off touch membrane switch with 4 stage dimming
- Unlimited range of movement
- Total wattage including driver 12W
- Australian designed and manufactured
- 3-year warranty on LED
- 2-year warranty on arm

MNLEDFLEX

\$895

Note: Light only - Please add your choice of mounting option

Wall Mount	MNLEDFLEXWM	\$75.00
Mobile Base	MNLEDFLEXTM	\$295.00

Custom mounting applications available if required



60,000 LUX AT 30CM

5YR warranty light
2YR warranty arm

IP65

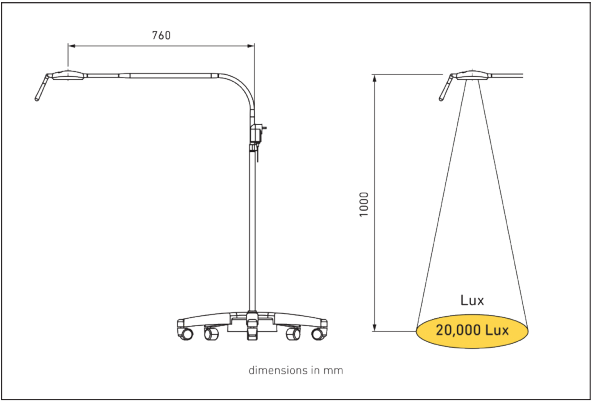

For more information download the product brochure from our website



Made in Australia

ULED examination light

Built to last yet cost effective, ULED’s unique features include its ingenious floating spring arm for intuitive positioning and its powerful 4000K beam with high colour performance.

Now with enhanced infection control and a sleek low-profile design. ULED’s cleaning procedures are complemented by the fully sealed head, touch sensitive membrane switch with dimming, and the removable handle which provides easy sterilisation.

The average LED life (L70) is 50,000 plus hours, which represents 15-20 years in normal use.

- Over 40,000 Lux at 1 metre
- Quick release head
- Sealed IP65 light head shaped for easy cleaning and sterilisation
- Low power consumption at 14W
- Low operational cost
- Next-to-zero maintenance
- All metal construction for durability
- Large task area action zone (Ø2100mm x 1850mm height adjustment)
- Multi axis head rotation
- Lightweight – only 6kg (including mounts) or <3kg (no mounts)
- Designed and manufactured in Australia
- 5-year warranty on LED and 15-year warranty on arm



80,000 LUX AT 30CM

5YR
warranty
light

15YR
warranty
arm



ULED Wall Model	MNLUEDUW	\$1490
length of reach 1258mm Also available extended wall mount with reach 1728mm		

ULED’s Push-to-release detachable head makes upgrading or exchanging easy whilst also allowing technician-free maintenance.



ULED Ceiling Model	MNLUEDFO	\$1150
--------------------	----------	--------

Please add ceiling extension pole separately

Extension Pole - Based on your ceiling height		
Below 2.5m	MNLUEDLC	\$1595
2.5m - 3m Ceiling	MNLUC3000	\$436
Up to 3.5m Ceiling	MNLUC3500	\$460

Custom mounting applications available if required.

★★★★★ PREMIUM PRODUCT



For more information scan the QR code to download the ceiling suspension form





PLANET
MEDICAL

Phantom minor procedure light

Phantom gives you the whole package: powerful lighting control over 70,000 lux @1m, exceptional colour performance and an advanced lightweight arm for effortless light positioning.

- Powerful 70,000 Lux at 1m
- Colour temperature: 4,000K
- Colour rendering (Ra): 96
- Light beam angle: 8°
- All metal construction for durability
- Quick access touch membrane switch with ON/OFF and 4 stage dimming
- Quick-release head for easy removal and exchange
- Arm has continuous rotation at 3 points; widest range of movement in today's market
- 50,000 hours LED life over 15 - 25 years in normal use
- Removable sterilisable handle
- Head shaped for ease of cleaning and sterilisation
- 11kg including ceiling mount
- Total wattage consumption 27W
- Australian designed and manufactured
- 5-year warranty on LED
- 15-year warranty on arm



For more information scan the QR code to download the ceiling suspension form

Wall model	MNPLPHANW	\$3895
Ceiling model	MNPLPHANC	\$3995

Custom mounting applications available if required



ask
for your
demo

100,000 LUX AT 30CM

5YR
warranty
light

15YR
warranty
arm

IP65



PLANET
MEDICAL

PentaLED 28

PentaLED 28 offers an exceptional shadow-suppressing light design, modern ergonomics and digital controls, and an effortless range of movement. Perfect for minor surgery, including gynaecology, day surgery and cosmetic procedures.

- Powerful 120,000 Lux @ 1m
- Shadow-suppressing (3D) light design for superior visibility
- Adjustable colour temperature 4500K-5000K
- High CRI 96 (4500K)
- Adjustable light field and focusing
- Sleek profile and contemporary design
- Exceptional arm control and easy manoeuvrability
- Removable handle ready for autoclave or easy sterilisation
- 3-year warranty on LED

Ceiling Light	MNLP28SO	\$8315
Mobile Light	MNLLD28	\$8315



BP Medical (WA) | www.teammed.com.au
PHONE 1300 33 55 60 | info@bpmedical.com.au

All prices are subject to 10% GST unless marked with * (GST Free)



Team Medical | www.teammed.com.au
PHONE 1300 22 44 50 | info@teammed.com.au

Perfect illumination in every examination situation.

LED illumination in HEINE Quality - LEDHQ





HEINE Examination Lights

There's LED. AND there's LED^{HQ}

HEINE Examination Lighting provides bright, shadow-free illumination precisely at the point of interest. There's LED. And there's LED^{HQ}. HEINE has set a new standard which maintains that only the best is good enough, from the selection of materials to processing, from light intensity to dimmability, and from thermal management to a colour rendering index as high as possible.

That's what we call LED in HEINE Quality – or LED^{HQ}.



HEINE EL3 LED[®] Examination Light

Simply Bright. The EL3 LED provides bright, shadow-free illumination precisely at the point of interest.

- Maintenance-free and easy to clean
- Shadow-free illumination
- Optimal positioning with lightweight head and solid gooseneck
- Up to 42,000 lux at 30cm
- Bright and homogeneous illumination field between 11-13cm
- Colour temperature 5000k
- Colour Rendering Index >80
- 3 mounting options: Wheeled stand, wall or table mount
- 5-year warranty



LED in HQ
Up to 42,000 Lux at 30 cm
Shadow-Free Illumination

EL3 Examination Light			
Wall Mount Model	HEJ00827011	RRP \$1325.00	\$1259
Mobile Base Model - Wheeled stand, metal base	HEJ00827014	RRP \$1788.00	\$1699



For more information download the product brochure from our website



HEINE EL10 LED[®] Examination Light

More Brightness. More Flexibility. More Possibilities.

- Bright and homogeneous illumination
- Coiled goose neck for perfect positioning
- Up to 45,000 lux at 30cm
- Solid construction and compact design
- Spot size diameter between 8.5 and 14cm
- Easy one-hand operation
- Colour temperature 3000k
- Hygienic design for efficient cleaning and disinfection
- Colour Rendering Index >90
- 3 mounting options: Wheeled stand, wall or table mount
- 5-year warranty



EL10 Examination Light			
Wall Mount Model	HEJ00827001	RRP \$2855.00	\$2713
Mobile Base Model - Wheeled stand, metal base	HEJ00827003	RRP \$3317.00	\$3152



For more information download the product brochure from our website



Welch Allyn®

GS 300 General Exam Light

Whiter, Brighter and Greener

Ideal for primary care facilities, emergency rooms, outpatient facilities and dermatology

- A single LED provides whiter, brighter light than halogen
- Perfect combination of intense light output and cool operation, all delivered in a compact design
- Affordable price and rugged performance
- 5 year limited warranty
- Light Intensity: 30,000 lux at 30cm
- Colour temperature: 5,500K
- Touchless On/Off Control

GS300 LED Examination light		
Light GS300 with Wall mount	WA44416	\$695
Light GS300 with Mobile base	WA44456	\$795



Welch Allyn®

Green Series Exam Light IV

Ideal for the OB/GYN office

- 3x the typical light output and features a highly flexible light pipe that is twice as long as conventional pipes
- Highly flexible pipe for easy maneuverability, helping to improve patient exams
- Pinpoint accuracy and true tissue color with 3x the output of a halogen source
- Help reduce risk of cross-contamination with touchless on/off
- LED life of 50,000 hours to maximize investment
- Improve patient comfort—minimal heat from LED
- Disposable sheath available to help reduce the risk of cross-contamination
- Light Intensity: 20,000 lux at 30cm
- Colour temperature: 5,500K

GS Exam Light IV			
GS Exam Light IV with wall/table mount	WA48816		\$1195
Mobile base for GS Exam Light IV	WA48950		\$395
Disposable Sheath for GS Exam Light IV	WA52640	Box/25	50.25



MEET OUR TEAM: ADRIENNE
SALES - WA

Adrienne has been looking after customers across WA for over 12 years and still loves it. She particularly loves the thrill of showing off the latest available equipment. Adrienne genuinely cares for her customers and offers product solutions that keep them operating smoothly for years.

Adrienne hopes to get to the Gold Coast or Singapore for her next big holiday. She can often be found catching a movie or at high tea. Her interests include home renovations and international cooking. Her last concert was a great night with an INXS tribute band.

What’s your favourite food? Japanese - Gyoza is the best
What is your biggest pet peeve? Slow drivers on the freeway





Welch Allyn®
GS 600 Minor Procedure Light

Whiter, Brighter and Greener

Ideal for minor procedures and exams in any healthcare environment

- Features 3 LEDs and a wider head specifically for demanding viewing conditions that require exceptionally good light
- Ideal for minor procedures and exams in any healthcare environment
- Touchless intensity controls provide the output you need, when you need it
- 5 year limited warranty
- Light Intensity: 75,000 lux at 30cm
- Working distance 12 in (30.5 cm) to 20 in (50 cm)
- Colour temperature: 5,500K
- Touchless On/Off Control

GS600 LED Minor Procedure light

Light GS600 with Wall Mount	WA44616	\$1195
Light GS600 with Mobile Base	WA44606	\$1395



Welch Allyn®
GS 900 Minor Procedure Light

Whiter, Brighter and Greener

Perfect for minor procedures in hospital or a physician's office

- Features 6 LEDs with intensity controls, outstanding durability, extraordinary maneuverability and unparalleled spot quality
- Ceiling mount option gives ability to maximize floor space and direct light wherever it is needed during a procedure
- Touchless intensity controls provide the output you need, when you need it
- 5 year limited warranty
- Light Intensity: 100,000 lux at 60cm
- Working distance 24 in (60.9 cm) to 40 in (100 cm)
- Colour temperature: 5,500K
- Touchless On/Off Control



GS900 LED Minor Procedure light

Light GS900 with Mobile Stand	WA44906	\$3095
Light GS900 with Wall Mount	WA44900	\$3125
Light GS900 with Ceiling Mount	WA44900C	\$3195

MEET OUR TEAM: RICARDO
CUSTOMER SERVICE/REPAIRS - NSW

We're getting close to Ric's 10 year anniversary with Team Medical. He has probably helped most of you by now – either on the phone, by servicing your equipment or packing your order.

You may not know that Rick was born in Portugal and that his last name means red head.

One of your pet peeves? Stopping a sentence midway

Apps you use every day? Tik Tok and Comic reader

What's a hobby of yours? Tinkering and gaming



VISIANO 10-1 - Examination Light

The Visiano 10-1 is an LED examination light which has been reduced to the essentials but that doesn't mean sacrificing professional light quality. For everyday use, the Visiano 10-1 will win you over with its excellent illumination intensity and large light field. The sturdy flexible arm ensures positional accuracy and good durability. The sealed construction protects against contamination.

- LED technology
- High illumination strength 50,000 lux / 0.5m
- Illuminated field 180mm
- Precise colour rendering Ra >93
- Colour temperature 4400K
- Professional light quality thanks to unique diamond optics and premium LEDs
- 280° rotation of the luminaire head
- Slimline design with ergonomic handle
- Long arm reach
- Maintenance-free
- High quality aluminum linkage and durable friction-joints
- Complies with the requirements of standards EN 60601-1 and EN 60601-2-41

Visiano 10-1 Wall model	RBKML501W
Wall bracket included	\$1245
Visiano 10-1 Mobile model	RBKML501S + RBKML131
light + mobile base	\$1474



VISIANO 20-2 LED Light

The Visiano LED exam light made by Derungs offers the best in LED medical lighting technology, combining low heat output with adjustable colour and brightness. This gives the medical staff complete control when carrying out minor procedures and general examinations.

- High illumination strength 60,000 lux at 0.5 m
- 16 premium LEDs with life-span > 50,000 hours
- 4 dimming levels
- Colour temperatures (3500K and 4500K) allow individual contrast viewing
- Maximum operating radius (head can be rotated about 360°)
- Large light field diameter of Ø 21cm. 20% more than conventional luminaires
- Fully enclosed light head rated according to IP20. Cleanable with disinfectant spray
- Highly adjustable and robust spring-balanced arm. Tested to 20,000 movement cycles

Adjustable colour temperature – a big plus

The light colour temperature of these lamps can be changed by a simple touch of the control panel on the lamp head. The user can select the optimum colour for the examination depending on the skin area and type of tissue or wound. The two colour temperatures are selectable on the touch panel.

Visiano 20-2 Mobile model	RBKML515M + RBKML131	\$2229
Visiano 20-2 Wall model	RBKML515W	\$1845
Visiano 20-2 Ceiling model with ceiling pole max 115cm (can be cut to length)	RBKML514	\$2995



reddot award 2014
winner



TRIANGO 100 - Procedure Light

The modular design of the TRIANGO 100 treatment luminaire meets all your requirements.

Experience Swiss Engineering: Wrapped in a small surgical luminaire in which long-standing experience in light technology and ergonomics merge.

The TRIANGO 100 provides optimum light conditions, thus making it a great assistant for any physician. At an illuminance of 100,000 Lux at 1.0 m, it enables precise interventions and accurate diagnoses - for the patient's benefit.

Features of TRIANGO 100-1 Model

- 9 LEDs with Ra 95
- Light Intensity: 100 000 Lux @ 1m
- 4 dimming levels (40 / 60 / 80 / 100 %)
- Unique arm system; Independent spring arm system with large angle of motion and radius of action
- Intuitive operation; Simple operation with an easy-to-reach keypad
- Detachable and sterilisable handle
- Illumination field diameter: 180mm
- Colour temperature Fixed 4300 K
- Complies with the requirements of standards EN 60601-1 and EN 60601-2-41
- 3-year warranty

Additional features with TRIANGO Fokus 100-3 Model

- Adjustable colour temperature: 3700K / 4300K / 4700K
- Focusable light field diameter: 18-28 cm



Explore the options

Take a closer look at the Triango procedure light.



Triango 100-1			Ceiling models are most popular
Triango 100-1 Floor Model	RBKML540	\$7195	
Triango 100-1 Wall Mounted Model	RBKML541	\$6835	
Triango 100-1 Ceiling Mounted Model	RBKML542	\$6835	

Triango Fokus 100-3			Ceiling models are most popular
Triango Fokus 100-3 Focusable, Adjustable colour Temperature - Floor Model	RBKML523	\$8525	
Triango Fokus 100-3 Focusable, Adjustable colour Temperature - Wall Mounted Model	RBKML524	\$7920	
Triango Fokus 100-3 Focusable, Adjustable colour Temperature - Ceiling Mounted Model	RBKML525	\$7920	



reddot winner 2020



MEET OUR TEAM: TASH

Tash recently started as our Risk and Compliance Manager, keeping on top of our ever-evolving processes and records. She helps to keep us all safe and in order while we keep doing what we love. Outside work Tash loves swimming, playing squash, baking, pets and gardening.

A fact about yourself? I paint miniatures
Last live show? The comedian Michael McIntyre

RISK & COMPLIANCE - NSW

