

EAR SYRINGE LEVER ACTION

For use in the removal of cerumen along the outer ear canal.

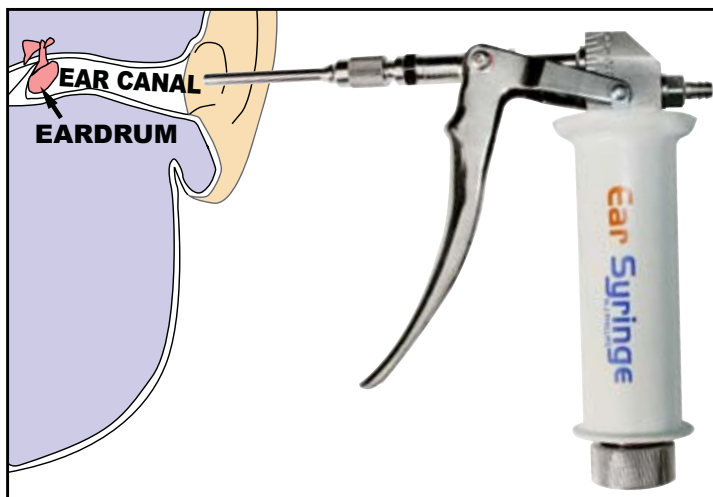

CAUTION:

1. DO NOT insert the ear tip end into the outer ear canal.
2. Take due care - rapid jets of water directed at the tympanic membrane could be harmful.
3. This device should only be used by a health care professional familiar with ear syringing techniques.

ARTG No: 145575

ASSEMBLING METAL TIP UNIT:

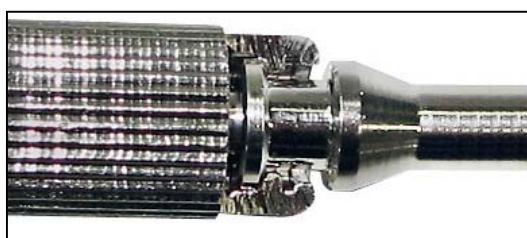

1. Loosen needle nut until reasonably loose.
2. Slide needle tip base into the lower slot of the needle nut.
3. Screw the needle nut tightly back onto the main threaded mount.

ASSEMBLING SILICONE TIP UNIT:



1. The silicone tip **MUST** always be sterilised prior to use.
2. Remove the metal tip and needle nut.
3. Push the silicone tip onto the main threaded mount. Turn clockwise as you push to ensure it is firmly in place.

Packs of 25 silicone tips are available from your distributor – Order Code: SP1370B.

CLEANING OR STERILISATION:

The following items may be autoclaved:

Ear tips needle; needle nut; the entire lever action hand piece – however it is important to apply a small drop of NJ Phillips Lubricant to any moving part post autoclave as good maintenance. To apply NJ Phillips Lubricant to moving parts within the handle grip, carefully unscrew counter clock wise.



The rubber tip is designed to be autoclaved at temperatures of **up to** 250 degrees celsius for **up to** 3.5 hours.



Make sure the thread is properly engaged when reconnecting the handle grip. To reconnect handle grip, gently pull lever trigger until the handle grip cover slides up and over the handle body and screw clock wise until tight – DO NOT OVER TIGHTEN!

It is unnecessary, nor desirable, to dismantle any part of the lever action unit for any purpose other than to lubricate moving parts.



DO NOT autoclave the hose piece, rather wash in a good quality Medical Equipment & Instrument detergent, then hang to drip dry.

LIQUID MEASURE DISPERSMENT SETTINGS:



CIRCULAR NUT

1. To set liquid dispersment adjust the circular nut located at the bottom of the handle. Turn the circular nut clockwise or counter clockwise to adjust the (ml) calibrations printed at the top of the body post. Adults generally require 3-5 (ml) setting. The dose is set from the bottom of the lever arm.



DOSE SETTING

BODY POST

2. Prime instrument to ensure all air is removed prior to use on the patient.

CARE AND MAINTENANCE

1. Clean ear tip and needle nut by brushing with a non wire brush in a good quality Medical Equipment & Instrument detergent prior to autoclave process.
2. Autoclave the unit as indicated in 'CLEANING OR STERILISATION' when required.
3. Draw a small quantity of NJ Phillips Lubricant into the lever action unit through the inlet fitting (where the hose attaches to the back of the unit) to maintain a well-lubricated action.
4. Place a few drops of NJ Phillips Lubricant in all moving parts to ensure a smooth action.

KIT-PAS1043: When using KIT-PAS1043 to service your Ear Syringe, ensure the valves are placed in the correct sequence, as shown in the diagram below.

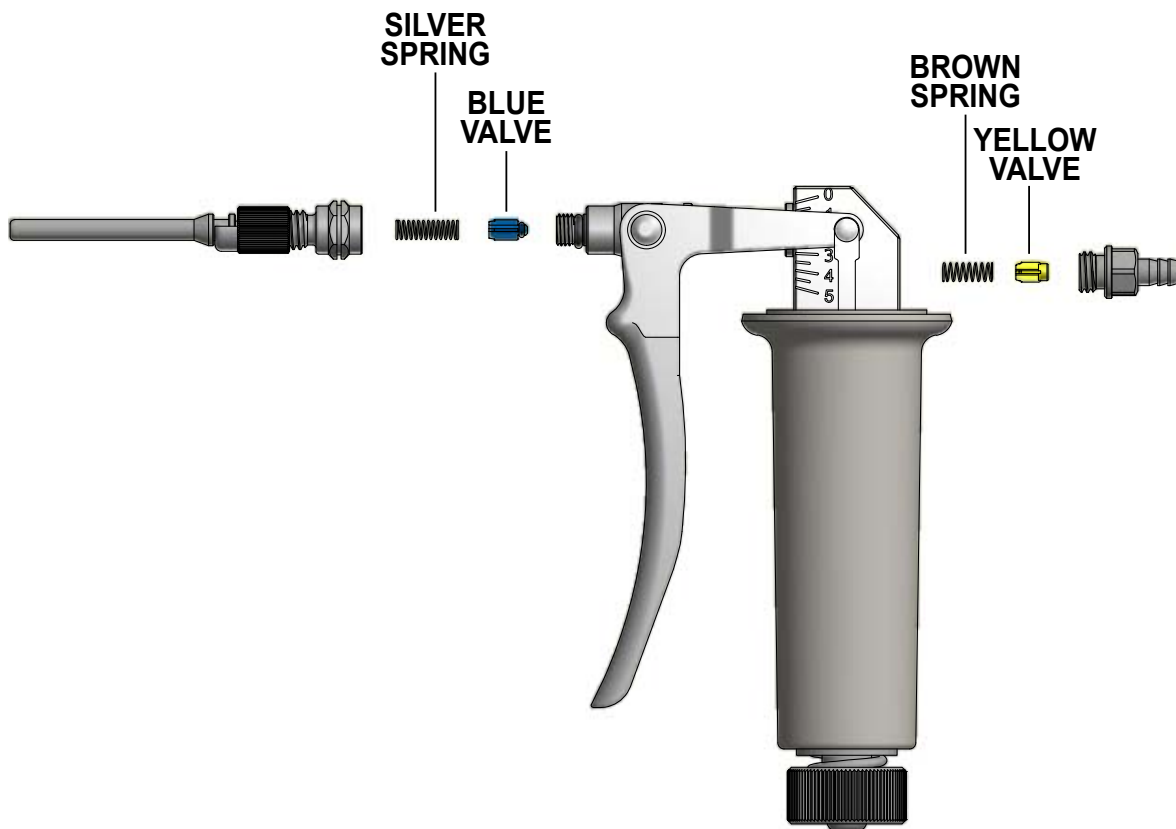

Supplied by

team medical supplies

✉ P.O. Box 6245 Dural DC, NSW 2158

☎ 1300 22 44 50

☎ 1300 22 44 60

@ info@teammed.com.au

🌐 www.teammed.com.au



Ph: 1300 009 663 Fax: 1300 099 300
Email: info@zonemedical.com.au
7/22 Mavis Court, Yatala, Qld, 4207
www.zonemedical.com.au