

# Meditrax

## Label applicator

Professional labelling for Health Care Professionals

- Durability
- Ease of Use
- Fit for the purpose



# Meditrax

## Label applicator

Knowing your label applicator

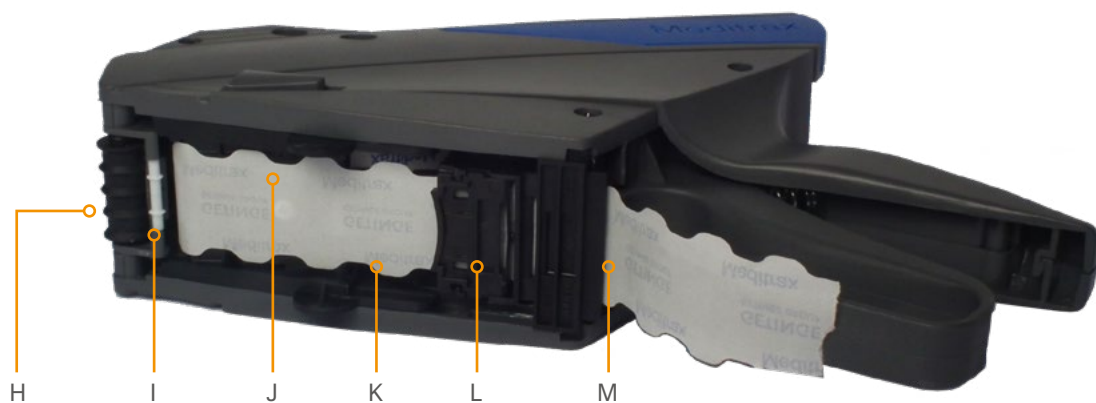
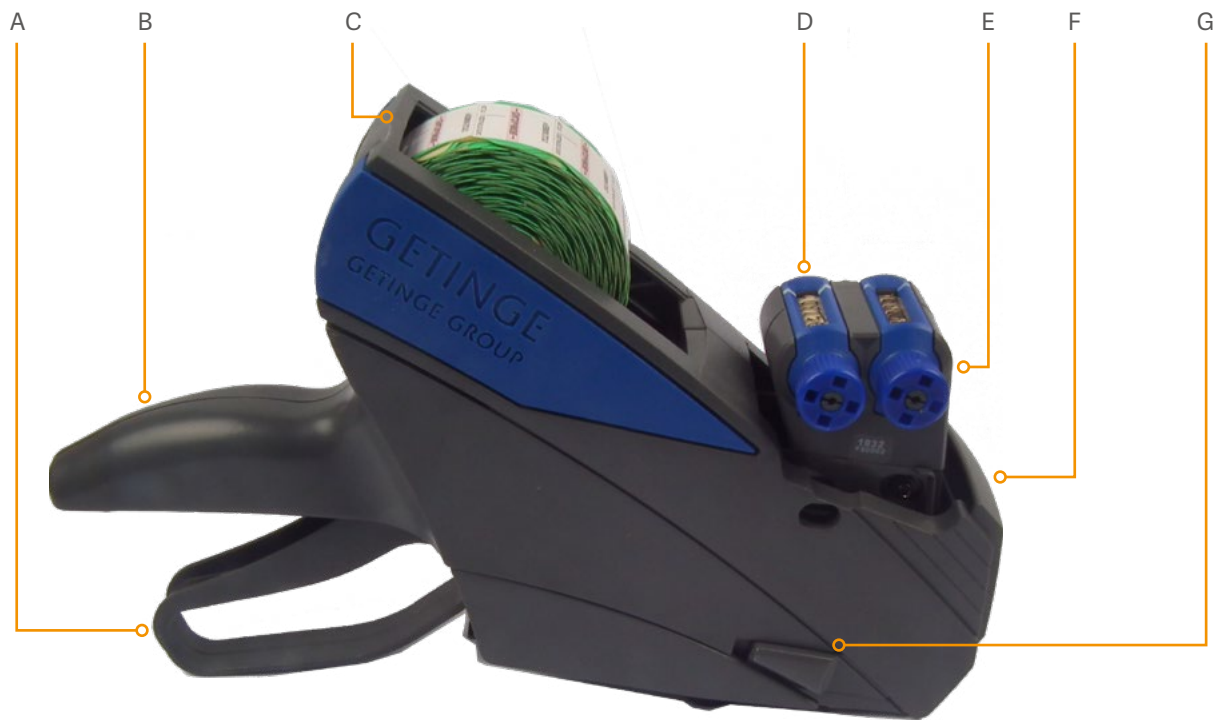

- A Handle lever
- B Handle
- C Label roll holder
- D Dialing/Viewing area of printhead
- E Dialing knob printhead
- F Front cover
- G Base plate retaining latches (on both sides)

- H Label applicator roller
- I Label guide
- J Base plate
- K Label backing paper
- L Transport unit
- M Tear-off edge for backing paper

# Meditrax

## Label applicator

To load the label applicator

1. Open the base plate (J) using the base plate retaining latches (G). Slide the latches on both sides of the label applicator to open the base plate.



2. Pull out approximately 15cm of labels and feed the labels down through the label applicator.



3. Slide the new label roll into the label roll holder (C) until the label core snaps into place. The labels should be placed in the holder with the label side facing up.



4. Turn the label applicator over and pull the labels through so they hang over the front of the applicator. Click the base plate (J) closed.

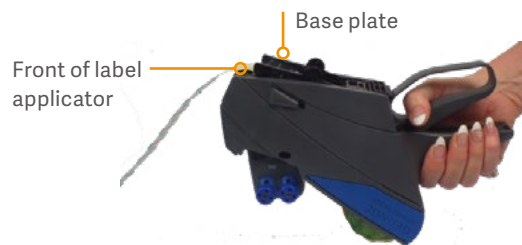

5. Feed the labels through and out the back of the transport unit (L) until the labels emerge between the tear-off edge (M) and the handle lever (A).

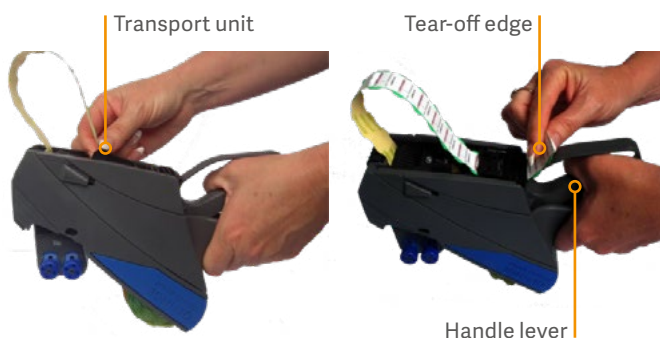

6. Turn the label applicator over and squeeze the handles (A+B) repeatedly to tighten, self align and cause a printed label to be dispensed.

# Meditrax

## Label applicator

### Changing the ink roller

1. Hold the label applicator horizontally and pull open the front cover (F) and leave open.



2. Squeeze the handles (A+B) together, and hold. The yellow ink roller will appear in the front opening and can be easily removed.



3. To insert the new ink roller, squeeze the handles (A+B) together, and hold.

4. While keeping your thumb on the word "TOP" insert the new ink roller into the guide channels and push up into label applicator and release handles. Always check that the studs of the ink roller move within the guide channels.

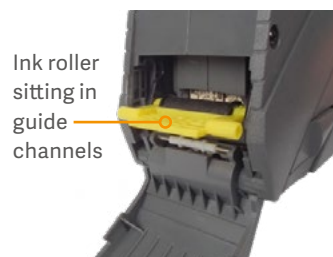
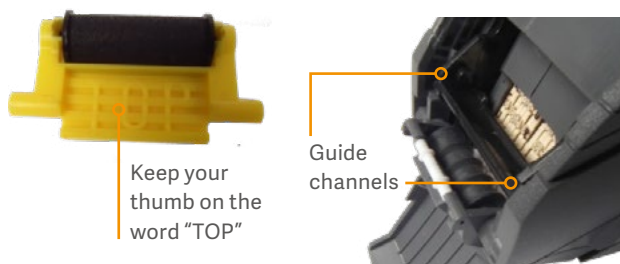

5. Close the front cover (F), by clicking it shut. The label applicator is now ready for operating.

# Meditrax

## Label applicator

### Troubleshooting - Common Errors

#### Correct placement of Clip

Correct placing of the clip should be the clip facing up and tucked under the back tear off bar.

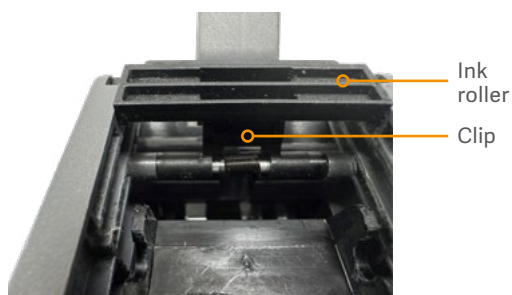

#### Incorrect placement of Clip

Often the clip is placed incorrectly placing down away from the clip, as seen in the image above.

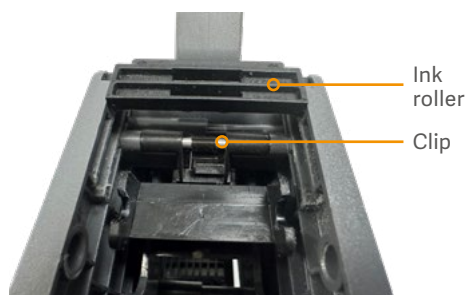

#### Ink Roller Placement

A quick and easy way to identify if the ink roller is place incorrectly is if you can see the word "TOP" from underneath the gun. See above image of incorrectly loaded ink roller. Please refer to the "Changing the ink roller" instructions on the previous page for guidance.



Click or scan here to access the  
Meditrax Applicator Tutorial Video

**Important:** Please note the ink pad cannot be re-inked.

#### Cleaning your Label Applicator

External surfaces of the label applicator can be decontaminated with an alcohol wipe. It is suggested that this is completed on a routine basis. Please be careful when adjusting or cleaning your Label Applicator not to pull it apart.

© 2023 Getinge Australia Pty Ltd ABN 67 009 673 518  
Australian Phone: 1800 438 464 Email: sales.au@getinge.com  
New Zealand Phone: 0800 1 438 464 Email: sales.nz@getinge.com

[www.getinge.com/anz](http://www.getinge.com/anz)

GETINGE 